

# \$15,000 - 220 1230 Windermere Way, Edmonton

MLS® #E4442257

**\$15,000**

0 Bedroom, 0.00 Bathroom,  
Condo / Townhouse on 0.00 Acres

Windermere, Edmonton, AB

Parking stall only (#74). Can be included with the sale of Unit #110 - 1230 Windermere Way SW. Parking stall #74 is located right across from parking stall and storage unit #73 which is sold with Unit #110.

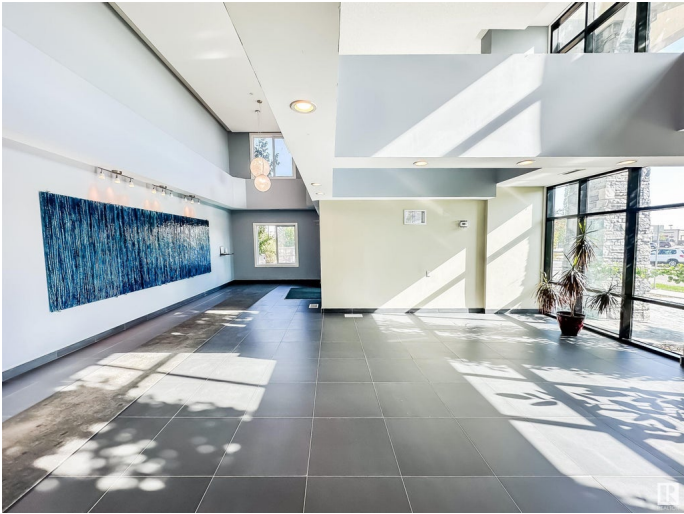

Built in 2011

## Essential Information

MLS® #	E4442257
Price	\$15,000
Bathrooms	0.00
Acres	0.00
Year Built	2011
Type	Condo / Townhouse
Sub-Type	Parking Stall
Status	Active

## Community Information

Address	220 1230 Windermere Way
Area	Edmonton
Subdivision	Windermere
City	Edmonton
County	ALBERTA
Province	AB
Postal Code	T6W 2J3

## Amenities

Parking Spaces     1  
Parking             Heated, Parkade, Stall, Underground

**Exterior**

Exterior Features    See Remarks

**Additional Information**

Date Listed           June 13th, 2025  
Days on Market     4  
Zoning                Zone 56  
Condo Fee            \$21

DATA IS DEEMED RELIABLE BUT IS NOT GUARANTEED ACCURATE BY THE REALTORS® ASSOCIATION OF EDMONTON. COPYRIGHT 2025 BY THE REALTORS® ASSOCIATION OF EDMONTON. ALL RIGHTS RESERVED.Trademarks are owned or controlled by the Canadian Real Estate Association (CREA) and identify real estate professionals who are members of CREA (REALTOR®, REALTORS®) and/or the quality of services they provide (MLS®, Multiple Listing Service®)  
Listing information last updated on June 17th, 2025 at 12:47am MDT