

**\$209,900**

Spring Lake Ranch, Rural Parkland County,  
AB

An aerial photograph of a residential property. A white outline highlights a specific area within the property, which appears to be a driveway or a cleared area with some debris. To the left of the outlined area is a large, two-story house with a dark roof and a chimney. The property is surrounded by lush green trees and a well-maintained lawn. A paved road is visible in the bottom left corner. In the bottom right corner, there is a logo for 'REALTOR' with a stylized 'R' inside a square.

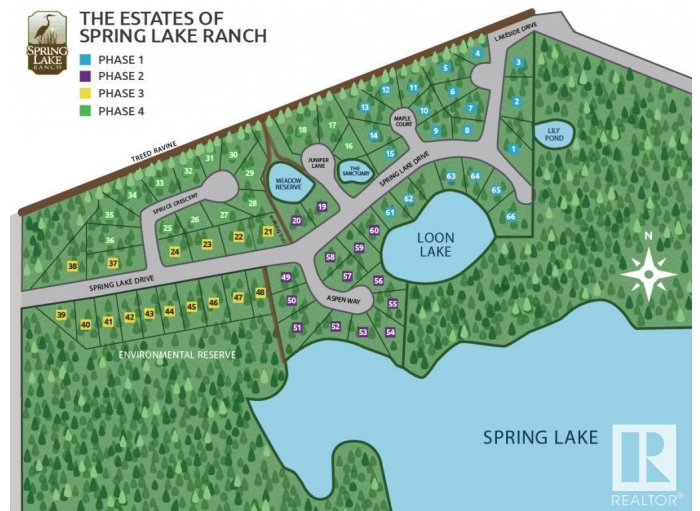

## Essential Information

MLS® #	E4422858
Price	\$209,900
Bathrooms	0.00

Acres	0.50
Type	Rural
Sub-Type	Vacant Lot/Land
Status	Active

### Community Information

Address	2063 Spruce Cres
Area	Rural Parkland County
Subdivision	Spring Lake Ranch
City	Rural Parkland County
County	ALBERTA
Province	AB
Postal Code	T7Z 2V3

### Exterior

Exterior Features	Backs Onto Park/Trees, Corner Lot, Flat Site, Lake Access Property, Picnic Area, Playground Nearby, Schools, Treed Lot
-------------------	--

### Additional Information

Date Listed	February 25th, 2025
Days on Market	68
Zoning	Zone 94

DATA IS DEEMED RELIABLE BUT IS NOT GUARANTEED ACCURATE BY THE REALTORS® ASSOCIATION OF EDMONTON. COPYRIGHT 2025 BY THE REALTORS® ASSOCIATION OF EDMONTON. ALL RIGHTS RESERVED. Trademarks are owned or controlled by the Canadian Real Estate Association (CREA) and identify real estate professionals who are members of CREA (REALTOR®, REALTORS®) and/or the quality of services they provide (MLS®, Multiple Listing Service®)

Listing information last updated on May 4th, 2025 at 12:02pm MDT